

Product Features

- electrical shut-off device, can be combined with flushing system
- low pressure loss
- wetted metal parts made of stainless steel and gunmetal
- two position actuator with limit sensor and actuator cut-off
- 90° rotatable
- water hammer free operation
- easy maintenance while installed
- maintenance free gear
- for integration in existing KHS mini control system
- self-centering shaft adapter with flange for assembly on the valve
- male union thread
- removable inner top part TOP-ENTRY, with EPDM gasket body and stainless steel ball
- free from dead spots

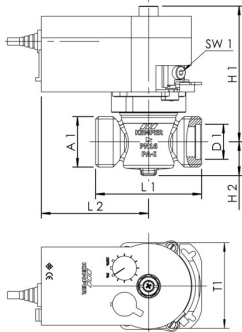

Standards and Approvals

- WRAS approval
- according to DVGW worksheet W 570
- according to accepted materials list from German environmental agency
- soundproofing certification according to DIN EN ISO 3822 Class 1
- DIN EN 13828
- ÜA-Reg.-Nr. R-15.2.3-21-17048, WIEN-ZERT

Technical data

- pressure rating PN 16
- max. operating temperature 75 °C
- max. ambient temperature 55 °C
- protection class IP54
- power supply 230 V AC
- elapsed time for actuated changeover 30 s
- length of connection cable 1.2 m
- wire cross section 3 x 0.75 mm²
- power input during actuation 2,4 W / 4,5 VA

Part no.	DN	A1	D1 (mm)	H1 (mm)	H2 (mm)	L1 (mm)	L2 (mm)	SW1 (mm)	T1 (mm)	kg
6860401500	15	G 3/4	18	110	25	73	89	4	72	1.41
6860402000	20	G 1	22.5	110	25	73	89	4	72	1.47
6860402500	25	G 1 1/4	29	112.5	28	88	89	4	72	1.71
6860403200	32	G 1 1/2	35	115.5	31	93	89	4	72	1.91

Accessories

- gunmetal solder union connector, figure 476 04
- gunmetal union connector, union nut, figure 476 06
- KHS Mini Control System SLAVE, figure 686 02 006
- KHS timer, figure 686 02 012
- gunmetal union connector, union nut, FPT, with drain valve, figure 476 07
- gunmetal union connector, union nut, MPT, figure 476 08
- flow limiter, figure 697
- insulation shell for quarter turn stop valves and CONTROL-PLUS sensors, figure 471 19
- solder / pressfit union connector, figure 476 14
- KHS free drain with overflow sensor, figure 688 00
- pressfit union connector, MAPRESS stainless steel and copper, figure 476 22
- pressfit union connector, SANPRESS and PROFIPRESS, figure 476 30
- pressfit union connector, SANHA and NiroSan, figure 476 35
- pressfit union connector, MEPLA, figure 476 40
- adaptor, double union nut, figure 101 06

Spare parts

- actuator 230V for KHS quarter turn stop valves, figure 686 00 005/006
- KHS quarter turn stop valve without servo drive, figure 686 0G
- inner top part for KHS quarter turn stop valves with actuator, figure E0120 686 00